

Project Name:	Part Number:	Type:
---------------	--------------	-------

# SQ-WB

## CURVED WIDE BASE WRAP



407-478-3759  
www.ilp-inc.com

### FEATURES

- 4ft and 8ft configurations
- Sleek curved profile frosted acrylic impact resistant lens
- .040" aluminum pre-painted white housing
- Ceiling, wall or suspension mounting options
- Suitable for installing in continuous runs
- ASLFMB Adjustable Sliding Fixture Mounting Box option will provide an pendant-ready solution perfect for retrofits when pendant locations are unknown or inconsistent
- 3000K - 5000K CCT
- 0-10V Dimmable Driver (100% - 10%)
- 120-277V Universal Voltage
- Calculated L70>100,000 hrs @ 25°C per TM-21-11
- 5 Year Warranty (std); 10 Year Warranty Optional
- ETL Listed for Damp Location
- DesignLights Consortium Qualified Luminaire
- Build America Buy America (BABA) Compliant



### SUITABLE APPLICATIONS

- Office
- Hospitals
- Education
- Hallways
- Work Station Task Lighting
- Multipurpose

### ORDERING GUIDE:

SERIES	LUMENS	DRIVER	CCT	BODY STYLE	WARRANTY	COMPLIANCE
SQ4	4ft Curved Wrap	2L 4L 6L	U 120-277V	<input checked="" type="checkbox"/> WB Wide Base	BLANK 5 Year 10YR <sup>1</sup> 10 Year	BABA Build America Buy America Compliant
SQ8	8ft Curved Wrap	4L 8L 12L				

#### OPTIONS

##### Factory Installed

Cx/yW	Cord (x=Length;6,10,15) (y=# of conductors; 3,4,5,6)
RW/3W <sup>2</sup>	3 Wire Raceway Wiring Harness for continuous wiring through fixture (non-dimming)
RW/5W <sup>2</sup>	5 Wire Raceway Wiring Harness for continuous wiring through fixture (dimming)
ASLFMB <sup>6</sup>	Adjustable Sliding Fixture Mounting Box system (with alignment bracket)
EM10/BABA <sup>9</sup>	Factory Installed 10W LED Battery Backup - BABA Compliant - CEC Title 20 Compliant

##### Ship With Accessories

WC <sup>7</sup>	11 GA Wire Cage
FMB <sup>3,4</sup>	Fixture Mounting Box
HUB 3/4 <sup>3,5</sup>	Conduit Hub ¾" for pendant mount
ACxY <sup>8</sup>	Y-Toggle Cable System (X=in)
ALBR <sup>2</sup>	Alignment Bracket (used to align fixtures mounted in continuous rows)

<sup>1</sup>Contact factory for more details

<sup>2</sup>Used only when mounting in continuous rows

<sup>3</sup>One needed per 4 ft section

<sup>4</sup>Must use with HUB3/4

<sup>5</sup>Must use with FMB

<sup>6</sup>Not available with 2 ft models

<sup>7</sup>Does not qualify for DLC

<sup>8</sup>Not BABA compliant

<sup>9</sup>Operation down to 32°F

Project Name:	Part Number:	Type:
---------------	--------------	-------

# SQ-WB

## CURVED WIDE BASE WRAP



407-478-3759  
www.ilp-inc.com

LED SYSTEMS INFO <sup>1</sup>	3000K CCT		3500K CCT		4000K CCT		5000K CCT		Watts <sup>2</sup>	CRI	Ambient Temperature Range
	Part #	Lumens	Efficacy	Lumens	Efficacy	Lumens	Efficacy	Lumens			
SQ4-2L-U-XX-WB	2,216 lm	144 lm/W	2,247 lm	146 lm/W	2,278 lm	148 lm/W	2,340 lm	152 lm/W	15 W	>80	-4°F to 113°F
SQ4-4L-U-XX-WB	4,060 lm	138 lm/W	4,117 lm	142 lm/W	4,174 lm	144 lm/W	4,288 lm	148 lm/W	29 W	>80	-4°F to 113°F
SQ4-6L-U-XX-WB	5,501 lm	128 lm/W	5,582 lm	130 lm/W	5,659 lm	131 lm/W	5,866 lm	135 lm/W	43 W	>80	-4°F to 113°F
SQ8-4L-U-XX-WB	4,574 lm	144 lm/W	4,620 lm	145 lm/W	4,665 lm	146 lm/W	4,757 lm	149 lm/W	32 W	>80	-4°F to 113°F
SQ8-8L-U-XX-WB	7,715 lm	133 lm/W	7,792 lm	134 lm/W	7,869 lm	135 lm/W	8,023 lm	138 lm/W	58 W	>80	-4°F to 113°F
SQ8-12L-U-XX-WB	10,500 lm	121 lm/W	10,605 lm	123 lm/W	10,710 lm	124 lm/W	10,920 lm	126 lm/W	87 W	>80	-4°F to 113°F

<sup>1</sup>LED Chips are frequently updated therefore values are nominal

<sup>2</sup>Electrical data at 25C (77F). Actual wattage may differ by +/-10%.

### OPTIONS



#### CORDx

Cords available in 6ft, 10ft, 12ft & 20ft (Inquire for additional options) Plug options available

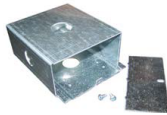

#### FMB

Includes rigid box to attach to the fixture, provides for dual point mounting to accept a pendant, hook or conduit hub (sold separately)



#### HUB 3/4

Conduit Hub 3/4" for Pendant Mounting



#### HB-XX-18Y-PAD

Includes 2 adjustable cable hangers. Available in 60", 120", 180" & 240"



#### ASLFMB

Adjustable Sliding Fixture Mounting Box system (with alignment bracket)

Project Name:

Part Number:

Type:

# SQ-WB

## CURVED WIDE BASE WRAP



407-478-3759  
www.ilp-inc.com

### LINE DRAWINGS

#### 4ft Dimensions

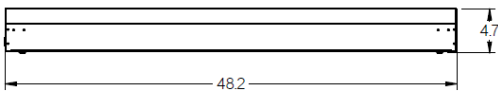
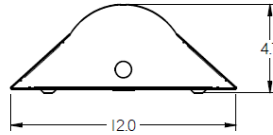
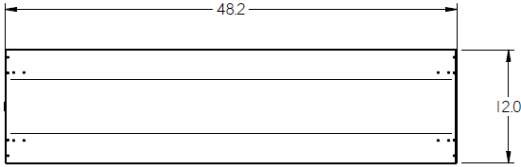

#### 8ft Dimensions

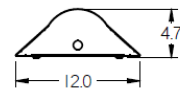
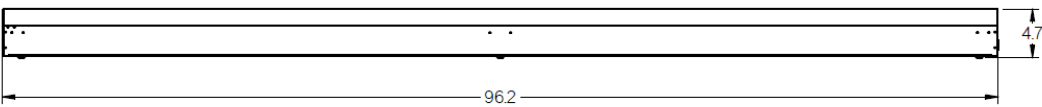
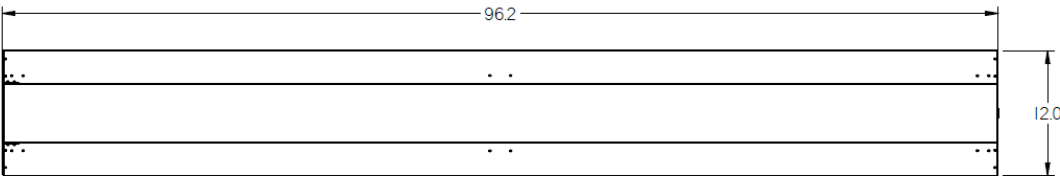

#### ASLFMB OPION DETAILS

##### 4ft Model

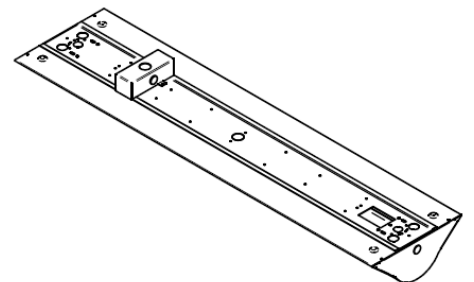
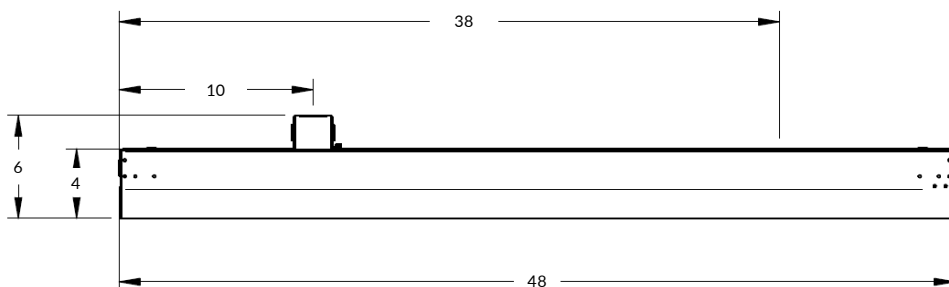

\*Dimensions shown above are applicable when the fixtures are the middle units of a continuously mounted set of fixtures.  
Please see installation instructions for limitations on end mounted fixtures.

# SQ-WB

## CURVED WIDE BASE WRAP



407-478-3759  
www.ilp-inc.com

### LINE DRAWINGS

#### 8ft Model

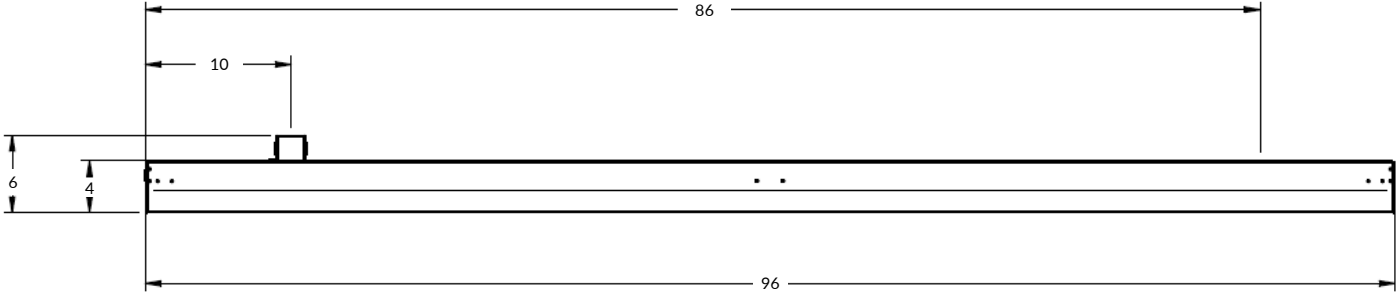

\*Dimensions shown above are applicable when the fixtures are the middle units of a continuously mounted set of fixtures. Please see installation instructions for limitations on end mounted fixtures.

### PHOTOMETRIC DATA

LUMINAIRE DATA	
Part Number	SQ4-4L-U-40-WB
Description	4ft Curved Wide Base Wrap, 4,000 Lumens, 4000K, Frosted Lens
Fixture Lumens (lm)	4178 lm
Wattage (W)	29W
Efficacy (lm/W)	144 lm/W
Mounting	Pendant
Spacing Criteria	0° = 1.19, 90° = 1.32

ZONAL LUMEN SUMMARY		
Zone	Lumens (lm)	% Fixture
0° - 40°	1587	38%
0° - 60°	2829	68%
0° - 90°	3956	95%
90° - 180°	222	5%
0° - 180°	4178	100%

